

## APPLICATION

Safety block is used to connect a hydraulic accumulator to a hydraulic circuit keeping safety rules.

## DESIGN DESCRIPTION

The unit consists of a housing incorporating the following sub-units:

- ball cut-off valve for connecting and disconnecting the accumulator with the hydraulic system
- manual relief valve for safe unloading of accumulator after cut-off
- the valve can be with UDT or CE certificate or without any certificate. If the valve is ordered with the certificate, it is set at the pressure required and sealed.
- solenoid directional valve for electric control of accumulator unloading (in directional valve version)
- threaded flange for connecting the unit to the accumulator (standard flanges enable connecting an EPE accumulator)



## TECHNAICAL DATA

Rated dimensions	20
Rated flow (at v=6 m/s)	150 dm <sup>3</sup> /min;
Working fluid	Mineral oil
Optimum working temperature range	258 up to 343 K
Max working pressure	33 MPa
Housing construction material	steel
Overflow valve type	DBDS10K... wg WK 450 610
Required oil filtration	up to 16 μm
Solenoid directional valve type	2URED6C1-01/2M1... NZ4 wg WK 494 920
Directional control valve voltage	12VDC; 24V DC or 220V 50 Hz
Solenoid power rating	26W
Weight	6,4 up to 6,9 kg

# OVERALL DIMENSIONS

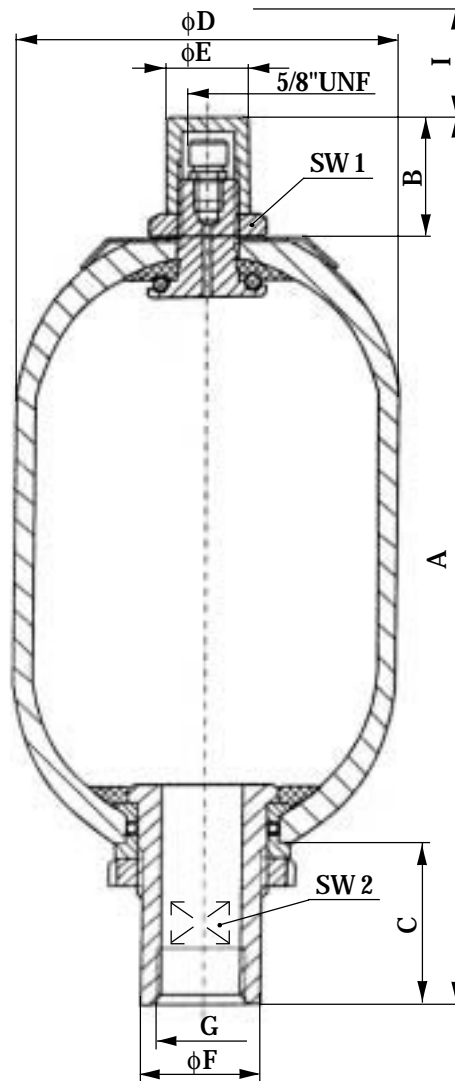

TYP	WEIGHT [kg]	G	A	B	C	ØD	ØE	ØF	SW 1	SW 2	I
BA 10	38	2"	556	60	101	220	55	77	70	70	140
BA 15	45		711								
BA 20	53		866								
BA 25	63		1026								
BA 35	83		1376								

# PERFORMANCE CURVES

DBDS10K... safety valve flow lines

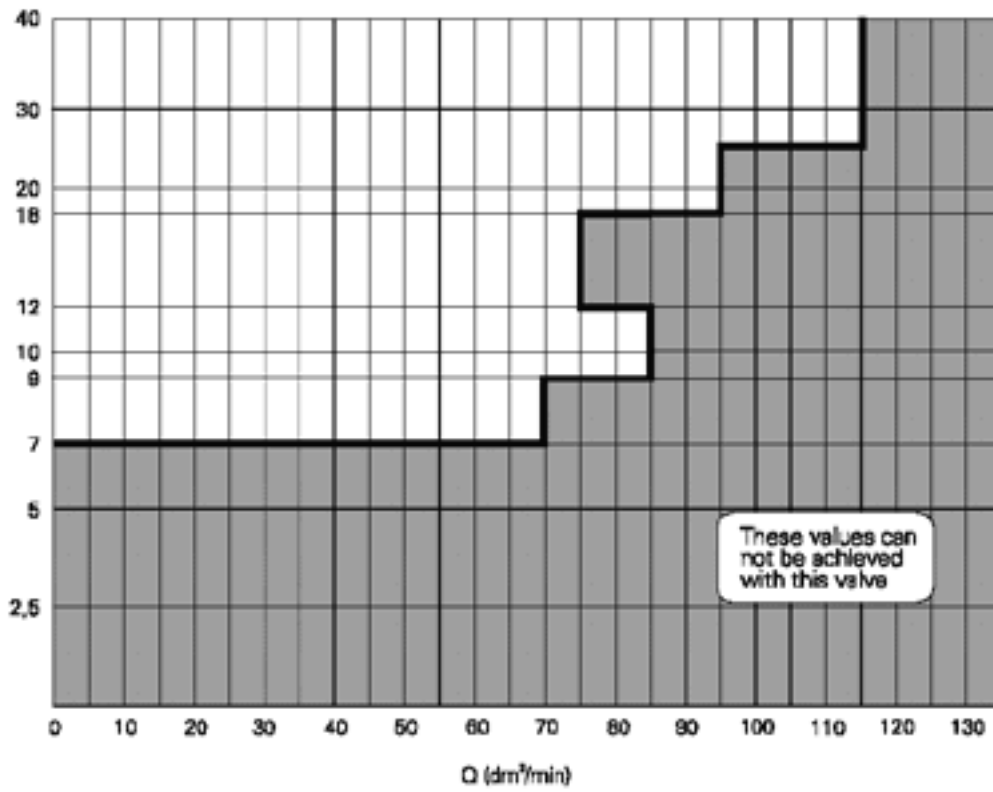

Version DBDS 10 as CE - approved safety valve

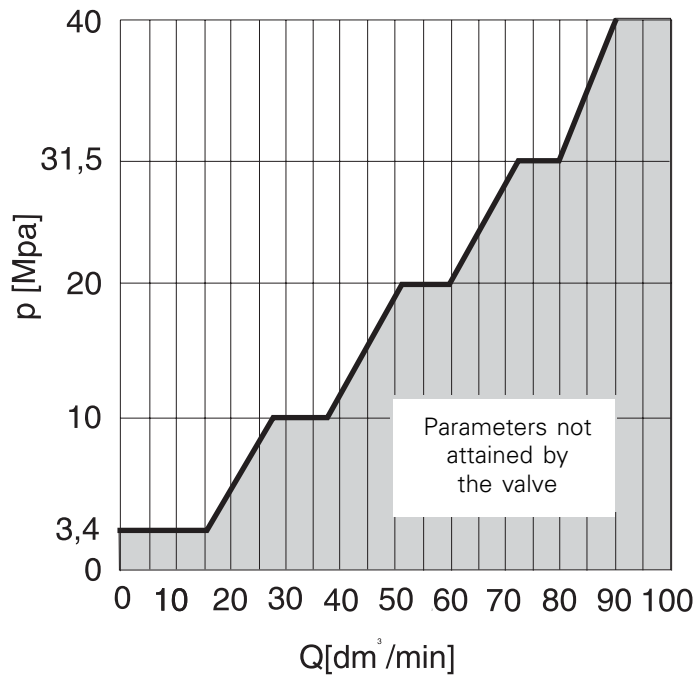

Version DBDS 10 as UDT - approved safety valve

## HOW TO ORDER

Orders coded in the way showed below should be forwarded to the manufacturer.



Relief manner:

Manual = M  
Manual and electric = R

Electric directional valve control voltage  
(version R only)

12 VDC = G12  
24 VDC = G24  
220V 50Hz = W220R

Overflow valve type:

No valve = A  
With preset valve (no approval) = B  
With sealed valve (with CE approval) = C  
With sealed valve (UDT - approved) = E

Safety valve setting

up to 2,5 MPa 25  
up to 5 MPa 50  
up to 10 MPa 100  
up to 20 MPa 200  
up to 31,5 MPa 315  
up to 33 MPa 330  
For UDT or with CE approval approved units, specify pressure setting  
(factory setting and sealing)

Accumulator connections

G2 connection = G  
G 1/4 connection = G1  
M 50x1,5 connection = M

Sealing

oilproof = P  
viton = V

Further requirements in clear text  
( to be agreed upon with the manufacturer )

CODING EXAMPLE:  
B 20MB100GRP

PONAR WADOWICE S.A.  
ul. Wojska Polskiego 29  
34-100 Wadowice  
tel. 033/ 823 39 43, 823 30 41  
fax 033/ 873 48 80  
e-mail: ponar@ponar-wadowice.pl

